

DURAFLEX® Friction Cups

Exceptional grip on oily surfaces



AMERICAS

ARGENTINA
Piab Argentina S.A.
25 de Mayo 1807
San Martín
AR-1650 BUENOS AIRES
Phone: +54 11 4713 8550
Fax: +54 11 4713 8552
Email: info-argentina@piab.com

BRAZIL

Regional office South America
Piab do Brasil Ltda.
R. Capitão Joaquim da Silva Rocha, 50
Jardim Ana Maria
BR-13208-750 JUNDIAÍ - SP
Phone: +55 11 4492 9050
Fax: +55 11 4522 4066
Email: info-brasil@piab.com

MEXICO

Piab Mexico & Central América
Querétaro, Mexico CP. 76190
Phone: +52 (442)228-5894
Email: info-mxca@piab.com

USA/CANADA

Regional office North America
Piab USA, Inc.
65 Sharp Street
HINGHAM MA US-02043
Phone: +1 781 337 7309
Fax: +1 781 337 6864
Email: info-usa@piab.com

ASIA

CHINA
Piab (Shanghai) Co., Ltd
Unit 401, Blk B1, No. 6000 Shenzhuan Rd
Songjiang District
CN-201619 SHANGHAI
Phone: +86 21 5237 6545
Fax: +86 21 5237 6549
Email: info-china@piab.com

INDIA

Piab Vacuum Technology Pvt. Ltd
Plot no 11/C8, 11th block,
Mugappair East,
IN-600 037 CHENNAI
Phone: +91 9444 25 36 48
Email: info-india@piab.com

JAPAN

Piab Japan Ltd.
3-11-23 Hikawacho,
JP-335-0027 TODA-SHI
Phone: +81 48 443 9148
Fax: +81 48 443 9179
Email: info-japan@piab.com

SINGAPORE

Regional office Asia Pacific
Piab Asia Pte Ltd
4008 Ang Mo Kio Ave 10
03-16 Techplace 1
SG-569625 SINGAPORE
Phone: +65 6455 7006
Fax: +65 6455 0081
Email: info-singapore@piab.com

SOUTH KOREA

Piab Korea Ltd
C-1906 Daelim Acrotel
KR-Kangnam-Gu 467-6
DOKOK-DONG
Phone: +82 2 3463 0751
Fax: +82 2 3463 0754
Email: info-korea@piab.com

EUROPE

FRANCE

Piab
Parc d'entreprises L'Esplanade
10 rue Enrico Fermi
Saint-Thibault des Vignes
FR-77462 LAGNY SUR MARNE Cedex
Phone: +33 1 6430 8267
Fax: +33 1 6430 8285
Email: info-france@piab.com

GERMANY

Regional office Europe
Piab Vakuum GmbH
Schorbachstr. 9
DE-35510 BUTZBACH
Phone: +49 6033 80600
Fax: +49 6033 80699
Email: info-germany@piab.com

GREAT BRITAIN

Piab Ltd.
Vacuum Innovation House
Station Road
GB-LE12 6LQ EAST LEAKE
Phone: +44 1509 857 010
Fax: +44 1509 857 011
Email: info-uk@piab.com

ITALY

Piab ITALIA Srl
Via Cuniberti, 58
IT-10151 TORINO
Phone: +39 011 226 36 66
Fax: +39 011 226 21 11
Email: info-italy@piab.com

POLAND

Piab Polska Sp. z o.o.
Ul. Astronomow 1
PL-80-299 GDANSK
Phone: +48 58 785 08 50
Fax: +48 58 785 08 51
Email: info-poland@piab.com

SPAIN

Vacio Piab, S.L.
Avda. Pineda, 2
CASTELDEFELS
ES-08860 BARCELONA
Phone: +34 93 6333876
Fax: +34 93 6380848
Email: info-spain@piab.com

SWEDEN

Head office
Piab AB
Box 4501
SE-183 04 TÄBY
Phone: +46 8 630 25 00
Fax: +46 8 630 26 90
Email: info-sweden@piab.com

SWITZERLAND

Piab Vakuum AG
Stückirain 1
CH-3266 WILER BEI SEEDORF
Phone: +41 32 391 21 10
Fax: +41 32 391 21 11
Email: info-ch@piab.com

No need to compromise.

www.piab.com

Art. No. 0120728GB, Rev.2 / Piab AB, 2011
Printed by Elanders AB, Sweden.

 piab



 piab

DURAFLEX® Friction Cups

Improve productivity with state of the art friction cups for oily surfaces

- ▶ Increase machine speed with extra grip (or use less suction cups per handling station with same friction/shear force).
- ▶ No slippage during an Emergency-stop.
- ▶ Longer intervals between cup changes, the cup maintains performance over time.
- ▶ DURAFLEX® dual hardness design provides a strong grip without damaging thin sheets.

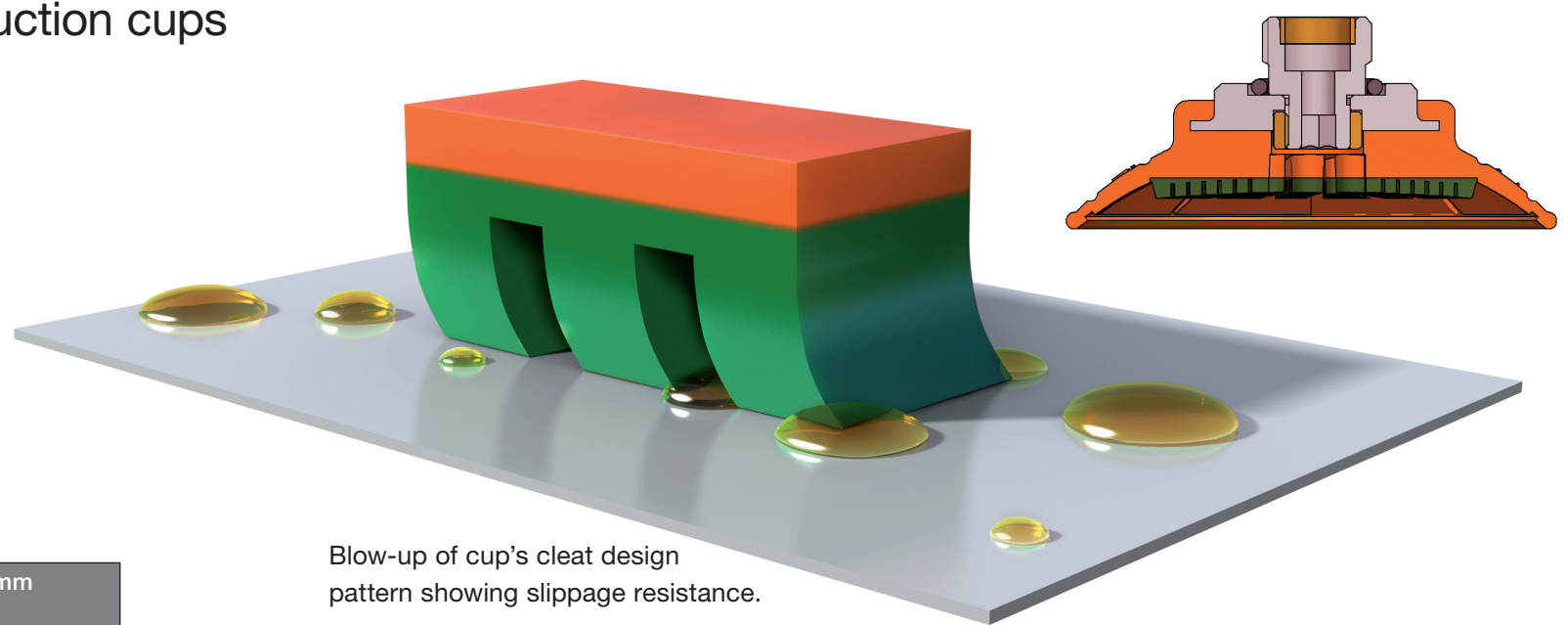

Lifting forces and measurements

| Model | Friction/shear forces parallel to the surface, N, at vacuum level | | General dimensions in mm | |
|------------|---|---------|--------------------------|------|
| | 60 -kPa | 90 -kPa | X | Y |
| BFF40P | 35 | 45 | 45 | 22 |
| BFF60P | 76 | 93 | 61 | 26 |
| BFF80P | 110 | 160 | 85 | 37 |
| BFF110P | 235 | 256 | 115 | 53 |
| FCF35P | 26 | 32 | 35 | 19 |
| FCF50P | 52 | 70 | 50 | 24 |
| FCF75P | 104 | 139 | 75 | 22 |
| FCF100P | 139 | 205 | 100 | 26 |
| FCF125P | 194 | 236 | 126 | 32 |
| OBF35x90P | 105 | 151 | 50x105 | 29 |
| OBF50x140P | 271 | 347 | 67x157 | 37 |
| OBF65x170P | 538 | 665 | 82x187 | 44 |
| OCF20x80P | 35 | 48 | 24x84 | 27.6 |
| OCF30x90P | 51 | 74 | 32.5x92.5 | 27.0 |
| OCF40x110P | 54 | 78 | 43x113 | 32.5 |

Values valid for steel sheet with surface finish Ra 1 and press oil content of 2-3 g/m².

Suction cup friction/shear force on oily sheet metal surfaces

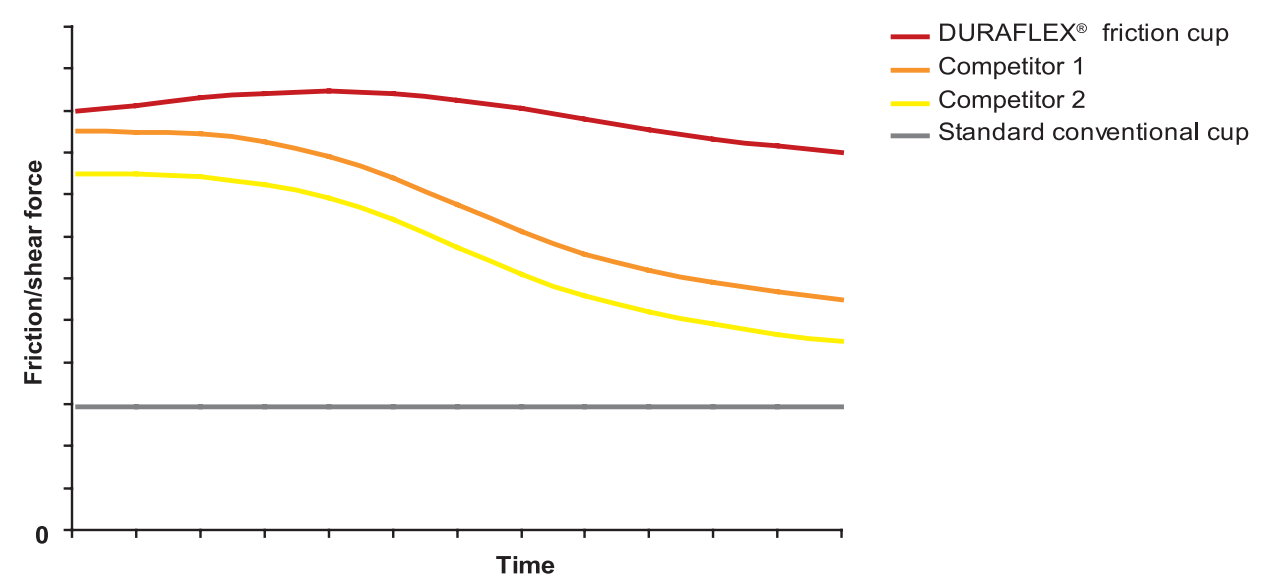

| BFF-P | BFF40P | BFF60P | BFF80P | BFF110P | | | | | | | | | | | | | | | | | | | | | | | | | | | | | | | | | | | | | | | | | | | | | | | | |
|-----------------|---|----------|--------|----------|------------|----------------|---------|--------------|----------------|---------|-----------------|----------------|---------|---|--------|------|----------|------------|----------------|---------|--------------|----------------|---------|-----------------|----------------|---------|---|--------|------|----------|------------|----------------|---------|--------------|----------------|---------|-----------------|----------------|---------|--|--------|------|----------|------------|-----------------|---------|--------------|-----------------|---------|-----------------|-----------------|---------|
| | | | | | | | | | | | | | | | | | | | | | | | | | | | | | | | | | | | | | | | | | | | | | | | | | | | | |
| | <table border="1"> <thead> <tr> <th>Thread</th> <th>Code</th> <th>Art. No.</th> </tr> </thead> <tbody> <tr> <td>G3/8" male</td> <td>BFF40P.4R.04UF</td> <td>0118991</td> </tr> <tr> <td>G3/8" female</td> <td>BFF40P.4R.04UA</td> <td>0118992</td> </tr> <tr> <td>3/8" NPT female</td> <td>BFF40P.4R.04UN</td> <td>0122278</td> </tr> </tbody> </table> | Thread | Code | Art. No. | G3/8" male | BFF40P.4R.04UF | 0118991 | G3/8" female | BFF40P.4R.04UA | 0118992 | 3/8" NPT female | BFF40P.4R.04UN | 0122278 | <table border="1"> <thead> <tr> <th>Thread</th> <th>Code</th> <th>Art. No.</th> </tr> </thead> <tbody> <tr> <td>G3/8" male</td> <td>BFF60P.4R.06UF</td> <td>0118994</td> </tr> <tr> <td>G3/8" female</td> <td>BFF60P.4R.06UA</td> <td>0118995</td> </tr> <tr> <td>3/8" NPT female</td> <td>BFF60P.4R.06UN</td> <td>0122279</td> </tr> </tbody> </table> | Thread | Code | Art. No. | G3/8" male | BFF60P.4R.06UF | 0118994 | G3/8" female | BFF60P.4R.06UA | 0118995 | 3/8" NPT female | BFF60P.4R.06UN | 0122279 | <table border="1"> <thead> <tr> <th>Thread</th> <th>Code</th> <th>Art. No.</th> </tr> </thead> <tbody> <tr> <td>G3/8" male</td> <td>BFF80P.5R.G45M</td> <td>0118997</td> </tr> <tr> <td>G3/8" female</td> <td>BFF80P.5R.G45W</td> <td>0118670</td> </tr> <tr> <td>3/8" NPT female</td> <td>BFF80P.5R.N47W</td> <td>0122280</td> </tr> </tbody> </table> | Thread | Code | Art. No. | G3/8" male | BFF80P.5R.G45M | 0118997 | G3/8" female | BFF80P.5R.G45W | 0118670 | 3/8" NPT female | BFF80P.5R.N47W | 0122280 | <table border="1"> <thead> <tr> <th>Thread</th> <th>Code</th> <th>Art. No.</th> </tr> </thead> <tbody> <tr> <td>G3/8" male</td> <td>BFF110P.5R.G45M</td> <td>0118671</td> </tr> <tr> <td>G3/8" female</td> <td>BFF110P.5R.G45W</td> <td>0118673</td> </tr> <tr> <td>3/8" NPT female</td> <td>BFF110P.5R.N47W</td> <td>0122281</td> </tr> </tbody> </table> | Thread | Code | Art. No. | G3/8" male | BFF110P.5R.G45M | 0118671 | G3/8" female | BFF110P.5R.G45W | 0118673 | 3/8" NPT female | BFF110P.5R.N47W | 0122281 |
| Thread | Code | Art. No. | | | | | | | | | | | | | | | | | | | | | | | | | | | | | | | | | | | | | | | | | | | | | | | | | | |
| G3/8" male | BFF40P.4R.04UF | 0118991 | | | | | | | | | | | | | | | | | | | | | | | | | | | | | | | | | | | | | | | | | | | | | | | | | | |
| G3/8" female | BFF40P.4R.04UA | 0118992 | | | | | | | | | | | | | | | | | | | | | | | | | | | | | | | | | | | | | | | | | | | | | | | | | | |
| 3/8" NPT female | BFF40P.4R.04UN | 0122278 | | | | | | | | | | | | | | | | | | | | | | | | | | | | | | | | | | | | | | | | | | | | | | | | | | |
| Thread | Code | Art. No. | | | | | | | | | | | | | | | | | | | | | | | | | | | | | | | | | | | | | | | | | | | | | | | | | | |
| G3/8" male | BFF60P.4R.06UF | 0118994 | | | | | | | | | | | | | | | | | | | | | | | | | | | | | | | | | | | | | | | | | | | | | | | | | | |
| G3/8" female | BFF60P.4R.06UA | 0118995 | | | | | | | | | | | | | | | | | | | | | | | | | | | | | | | | | | | | | | | | | | | | | | | | | | |
| 3/8" NPT female | BFF60P.4R.06UN | 0122279 | | | | | | | | | | | | | | | | | | | | | | | | | | | | | | | | | | | | | | | | | | | | | | | | | | |
| Thread | Code | Art. No. | | | | | | | | | | | | | | | | | | | | | | | | | | | | | | | | | | | | | | | | | | | | | | | | | | |
| G3/8" male | BFF80P.5R.G45M | 0118997 | | | | | | | | | | | | | | | | | | | | | | | | | | | | | | | | | | | | | | | | | | | | | | | | | | |
| G3/8" female | BFF80P.5R.G45W | 0118670 | | | | | | | | | | | | | | | | | | | | | | | | | | | | | | | | | | | | | | | | | | | | | | | | | | |
| 3/8" NPT female | BFF80P.5R.N47W | 0122280 | | | | | | | | | | | | | | | | | | | | | | | | | | | | | | | | | | | | | | | | | | | | | | | | | | |
| Thread | Code | Art. No. | | | | | | | | | | | | | | | | | | | | | | | | | | | | | | | | | | | | | | | | | | | | | | | | | | |
| G3/8" male | BFF110P.5R.G45M | 0118671 | | | | | | | | | | | | | | | | | | | | | | | | | | | | | | | | | | | | | | | | | | | | | | | | | | |
| G3/8" female | BFF110P.5R.G45W | 0118673 | | | | | | | | | | | | | | | | | | | | | | | | | | | | | | | | | | | | | | | | | | | | | | | | | | |
| 3/8" NPT female | BFF110P.5R.N47W | 0122281 | | | | | | | | | | | | | | | | | | | | | | | | | | | | | | | | | | | | | | | | | | | | | | | | | | |

| FCF-P | FCF35P | FCF50P | FCF75P | FCF100P | FCF125P | | | | | | | | | | | | | | | | | | | | | | | | | | | | | | | | | | | | | | | | | | | | | | | | | | | | | | | | | | | | |
|-----------------|---|----------|--------|----------|------------|----------------|---------|--------------|----------------|---------|-----------------|----------------|---------|---|--------|------|----------|------------|----------------|---------|--------------|----------------|---------|-----------------|----------------|---------|---|--------|------|----------|------------|----------------|---------|--------------|----------------|---------|-----------------|----------------|---------|--|--------|------|----------|------------|-----------------|---------|--------------|-----------------|---------|-----------------|-----------------|---------|--|--------|------|----------|------------|-----------------|---------|--------------|-----------------|---------|-----------------|-----------------|---------|
| | | | | | | | | | | | | | | | | | | | | | | | | | | | | | | | | | | | | | | | | | | | | | | | | | | | | | | | | | | | | | | | | | |
| | <table border="1"> <thead> <tr> <th>Thread</th> <th>Code</th> <th>Art. No.</th> </tr> </thead> <tbody> <tr> <td>G3/8" male</td> <td>FCF35P.4R.04UF</td> <td>0119913</td> </tr> <tr> <td>G3/8" female</td> <td>FCF35P.4R.04UA</td> <td>0118981</td> </tr> <tr> <td>3/8" NPT female</td> <td>FCF35P.4R.04UN</td> <td>0122282</td> </tr> </tbody> </table> | Thread | Code | Art. No. | G3/8" male | FCF35P.4R.04UF | 0119913 | G3/8" female | FCF35P.4R.04UA | 0118981 | 3/8" NPT female | FCF35P.4R.04UN | 0122282 | <table border="1"> <thead> <tr> <th>Thread</th> <th>Code</th> <th>Art. No.</th> </tr> </thead> <tbody> <tr> <td>G3/8" male</td> <td>FCF50P.4R.05UF</td> <td>0118985</td> </tr> <tr> <td>G3/8" female</td> <td>FCF50P.4R.05UA</td> <td>0118986</td> </tr> <tr> <td>3/8" NPT female</td> <td>FCF50P.4R.05UN</td> <td>0122283</td> </tr> </tbody> </table> | Thread | Code | Art. No. | G3/8" male | FCF50P.4R.05UF | 0118985 | G3/8" female | FCF50P.4R.05UA | 0118986 | 3/8" NPT female | FCF50P.4R.05UN | 0122283 | <table border="1"> <thead> <tr> <th>Thread</th> <th>Code</th> <th>Art. No.</th> </tr> </thead> <tbody> <tr> <td>G3/8" male</td> <td>FCF75P.5R.G45M</td> <td>0118423</td> </tr> <tr> <td>G3/8" female</td> <td>FCF75P.5R.G45W</td> <td>0118429</td> </tr> <tr> <td>3/8" NPT female</td> <td>FCF75P.5R.N47W</td> <td>0122284</td> </tr> </tbody> </table> | Thread | Code | Art. No. | G3/8" male | FCF75P.5R.G45M | 0118423 | G3/8" female | FCF75P.5R.G45W | 0118429 | 3/8" NPT female | FCF75P.5R.N47W | 0122284 | <table border="1"> <thead> <tr> <th>Thread</th> <th>Code</th> <th>Art. No.</th> </tr> </thead> <tbody> <tr> <td>G3/8" male</td> <td>FCF100P.5R.G40M</td> <td>0118430</td> </tr> <tr> <td>G3/8" female</td> <td>FCF100P.5R.G46W</td> <td>0118432</td> </tr> <tr> <td>3/8" NPT female</td> <td>FCF100P.5R.N48W</td> <td>0122285</td> </tr> </tbody> </table> | Thread | Code | Art. No. | G3/8" male | FCF100P.5R.G40M | 0118430 | G3/8" female | FCF100P.5R.G46W | 0118432 | 3/8" NPT female | FCF100P.5R.N48W | 0122285 | <table border="1"> <thead> <tr> <th>Thread</th> <th>Code</th> <th>Art. No.</th> </tr> </thead> <tbody> <tr> <td>G3/8" male</td> <td>FCF125P.5R.G40M</td> <td>0118435</td> </tr> <tr> <td>G3/8" female</td> <td>FCF125P.5R.G46W</td> <td>0118437</td> </tr> <tr> <td>3/8" NPT female</td> <td>FCF125P.5R.N48W</td> <td>0122286</td> </tr> </tbody> </table> | Thread | Code | Art. No. | G3/8" male | FCF125P.5R.G40M | 0118435 | G3/8" female | FCF125P.5R.G46W | 0118437 | 3/8" NPT female | FCF125P.5R.N48W | 0122286 |
| Thread | Code | Art. No. | | | | | | | | | | | | | | | | | | | | | | | | | | | | | | | | | | | | | | | | | | | | | | | | | | | | | | | | | | | | | | | |
| G3/8" male | FCF35P.4R.04UF | 0119913 | | | | | | | | | | | | | | | | | | | | | | | | | | | | | | | | | | | | | | | | | | | | | | | | | | | | | | | | | | | | | | | |
| G3/8" female | FCF35P.4R.04UA | 0118981 | | | | | | | | | | | | | | | | | | | | | | | | | | | | | | | | | | | | | | | | | | | | | | | | | | | | | | | | | | | | | | | |
| 3/8" NPT female | FCF35P.4R.04UN | 0122282 | | | | | | | | | | | | | | | | | | | | | | | | | | | | | | | | | | | | | | | | | | | | | | | | | | | | | | | | | | | | | | | |
| Thread | Code | Art. No. | | | | | | | | | | | | | | | | | | | | | | | | | | | | | | | | | | | | | | | | | | | | | | | | | | | | | | | | | | | | | | | |
| G3/8" male | FCF50P.4R.05UF | 0118985 | | | | | | | | | | | | | | | | | | | | | | | | | | | | | | | | | | | | | | | | | | | | | | | | | | | | | | | | | | | | | | | |
| G3/8" female | FCF50P.4R.05UA | 0118986 | | | | | | | | | | | | | | | | | | | | | | | | | | | | | | | | | | | | | | | | | | | | | | | | | | | | | | | | | | | | | | | |
| 3/8" NPT female | FCF50P.4R.05UN | 0122283 | | | | | | | | | | | | | | | | | | | | | | | | | | | | | | | | | | | | | | | | | | | | | | | | | | | | | | | | | | | | | | | |
| Thread | Code | Art. No. | | | | | | | | | | | | | | | | | | | | | | | | | | | | | | | | | | | | | | | | | | | | | | | | | | | | | | | | | | | | | | | |
| G3/8" male | FCF75P.5R.G45M | 0118423 | | | | | | | | | | | | | | | | | | | | | | | | | | | | | | | | | | | | | | | | | | | | | | | | | | | | | | | | | | | | | | | |
| G3/8" female | FCF75P.5R.G45W | 0118429 | | | | | | | | | | | | | | | | | | | | | | | | | | | | | | | | | | | | | | | | | | | | | | | | | | | | | | | | | | | | | | | |
| 3/8" NPT female | FCF75P.5R.N47W | 0122284 | | | | | | | | | | | | | | | | | | | | | | | | | | | | | | | | | | | | | | | | | | | | | | | | | | | | | | | | | | | | | | | |
| Thread | Code | Art. No. | | | | | | | | | | | | | | | | | | | | | | | | | | | | | | | | | | | | | | | | | | | | | | | | | | | | | | | | | | | | | | | |
| G3/8" male | FCF100P.5R.G40M | 0118430 | | | | | | | | | | | | | | | | | | | | | | | | | | | | | | | | | | | | | | | | | | | | | | | | | | | | | | | | | | | | | | | |
| G3/8" female | FCF100P.5R.G46W | 0118432 | | | | | | | | | | | | | | | | | | | | | | | | | | | | | | | | | | | | | | | | | | | | | | | | | | | | | | | | | | | | | | | |
| 3/8" NPT female | FCF100P.5R.N48W | 0122285 | | | | | | | | | | | | | | | | | | | | | | | | | | | | | | | | | | | | | | | | | | | | | | | | | | | | | | | | | | | | | | | |
| Thread | Code | Art. No. | | | | | | | | | | | | | | | | | | | | | | | | | | | | | | | | | | | | | | | | | | | | | | | | | | | | | | | | | | | | | | | |
| G3/8" male | FCF125P.5R.G40M | 0118435 | | | | | | | | | | | | | | | | | | | | | | | | | | | | | | | | | | | | | | | | | | | | | | | | | | | | | | | | | | | | | | | |
| G3/8" female | FCF125P.5R.G46W | 0118437 | | | | | | | | | | | | | | | | | | | | | | | | | | | | | | | | | | | | | | | | | | | | | | | | | | | | | | | | | | | | | | | |
| 3/8" NPT female | FCF125P.5R.N48W | 0122286 | | | | | | | | | | | | | | | | | | | | | | | | | | | | | | | | | | | | | | | | | | | | | | | | | | | | | | | | | | | | | | | |

| OBF-P | OBF35x90P | OBF50x140P | OBF65x170P | | | | | | | | | | | | | | | | | | | | | | | | | | | | | | | | | | | | |
|-----------------|--|------------|------------|----------|------------|-------------------|---------|--------------|-------------------|---------|-----------------|-------------------|---------|---|--------|------|----------|------------|--------------------|---------|--------------|--------------------|---------|-----------------|--------------------|---------|---|--------|------|----------|------------|--------------------|---------|--------------|--------------------|---------|-----------------|--------------------|---------|
| | | | | | | | | | | | | | | | | | | | | | | | | | | | | | | | | | | | | | | | |
| | <table border="1"> <thead> <tr> <th>Thread</th> <th>Code</th> <th>Art. No.</th> </tr> </thead> <tbody> <tr> <td>G3/8" male</td> <td>OBF35x90P.5R.G40M</td> <td>0119121</td> </tr> <tr> <td>G3/8" female</td> <td>OBF35x90P.5R.G46W</td> <td>0119123</td> </tr> <tr> <td>3/8" NPT female</td> <td>OBF35x90P.5R.N48W</td> <td>0122287</td> </tr> </tbody> </table> | Thread | Code | Art. No. | G3/8" male | OBF35x90P.5R.G40M | 0119121 | G3/8" female | OBF35x90P.5R.G46W | 0119123 | 3/8" NPT female | OBF35x90P.5R.N48W | 0122287 | <table border="1"> <thead> <tr> <th>Thread</th> <th>Code</th> <th>Art. No.</th> </tr> </thead> <tbody> <tr> <td>G3/8" male</td> <td>OBF50x140P.5R.G40M</td> <td>0119125</td> </tr> <tr> <td>G3/8" female</td> <td>OBF50x140P.5R.G46W</td> <td>0119127</td> </tr> <tr> <td>3/8" NPT female</td> <td>OBF50x140P.5R.N48W</td> <td>0122288</td> </tr> </tbody> </table> | Thread | Code | Art. No. | G3/8" male | OBF50x140P.5R.G40M | 0119125 | G3/8" female | OBF50x140P.5R.G46W | 0119127 | 3/8" NPT female | OBF50x140P.5R.N48W | 0122288 | <table border="1"> <thead> <tr> <th>Thread</th> <th>Code</th> <th>Art. No.</th> </tr> </thead> <tbody> <tr> <td>G3/8" male</td> <td>OBF65x170P.5R.G40M</td> <td>0119129</td> </tr> <tr> <td>G3/8" female</td> <td>OBF65x170P.5R.G46W</td> <td>0119131</td> </tr> <tr> <td>3/8" NPT female</td> <td>OBF65x170P.5R.N48W</td> <td>0122289</td> </tr> </tbody> </table> | Thread | Code | Art. No. | G3/8" male | OBF65x170P.5R.G40M | 0119129 | G3/8" female | OBF65x170P.5R.G46W | 0119131 | 3/8" NPT female | OBF65x170P.5R.N48W | 0122289 |
| Thread | Code | Art. No. | | | | | | | | | | | | | | | | | | | | | | | | | | | | | | | | | | | | | |
| G3/8" male | OBF35x90P.5R.G40M | 0119121 | | | | | | | | | | | | | | | | | | | | | | | | | | | | | | | | | | | | | |
| G3/8" female | OBF35x90P.5R.G46W | 0119123 | | | | | | | | | | | | | | | | | | | | | | | | | | | | | | | | | | | | | |
| 3/8" NPT female | OBF35x90P.5R.N48W | 0122287 | | | | | | | | | | | | | | | | | | | | | | | | | | | | | | | | | | | | | |
| Thread | Code | Art. No. | | | | | | | | | | | | | | | | | | | | | | | | | | | | | | | | | | | | | |
| G3/8" male | OBF50x140P.5R.G40M | 0119125 | | | | | | | | | | | | | | | | | | | | | | | | | | | | | | | | | | | | | |
| G3/8" female | OBF50x140P.5R.G46W | 0119127 | | | | | | | | | | | | | | | | | | | | | | | | | | | | | | | | | | | | | |
| 3/8" NPT female | OBF50x140P.5R.N48W | 0122288 | | | | | | | | | | | | | | | | | | | | | | | | | | | | | | | | | | | | | |
| Thread | Code | Art. No. | | | | | | | | | | | | | | | | | | | | | | | | | | | | | | | | | | | | | |
| G3/8" male | OBF65x170P.5R.G40M | 0119129 | | | | | | | | | | | | | | | | | | | | | | | | | | | | | | | | | | | | | |
| G3/8" female | OBF65x170P.5R.G46W | 0119131 | | | | | | | | | | | | | | | | | | | | | | | | | | | | | | | | | | | | | |
| 3/8" NPT female | OBF65x170P.5R.N48W | 0122289 | | | | | | | | | | | | | | | | | | | | | | | | | | | | | | | | | | | | | |

| OCF-P | OCF20x80P | OCF30x90P | OCF40x110P | | | | | | | | | | | | | | | | | | | | | | | | | | | | | | | | | | | | |
|-----------------|--|-----------|------------|----------|------------|-------------------|---------|--------------|-------------------|---------|-----------------|-------------------|---------|--|--------|------|----------|------------|-------------------|---------|--------------|-------------------|---------|-----------------|-------------------|---------|---|--------|------|----------|------------|--------------------|---------|--------------|--------------------|---------|-----------------|--------------------|---------|
| | | | | | | | | | | | | | | | | | | | | | | | | | | | | | | | | | | | | | | | |
| | <table border="1"> <thead> <tr> <th>Thread</th> <th>Code</th> <th>Art. No.</th> </tr> </thead> <tbody> <tr> <td>G3/8" male</td> <td>OCF20x80P.5R.G41M</td> <td>0121847</td> </tr> <tr> <td>G3/8" female</td> <td>OCF20x80P.5R.G45W</td> <td>0122455</td> </tr> <tr> <td>3/8" NPT female</td> <td>OCF20x80P.5R.N47W</td> <td>0121859</td> </tr> </tbody> </table> | Thread | Code | Art. No. | G3/8" male | OCF20x80P.5R.G41M | 0121847 | G3/8" female | OCF20x80P.5R.G45W | 0122455 | 3/8" NPT female | OCF20x80P.5R.N47W | 0121859 | <table border="1"> <thead> <tr> <th>Thread</th> <th>Code</th> <th>Art. No.</th> </tr> </thead> <tbody> <tr> <td>G3/8" male</td> <td>OCF30x90P.5R.G41M</td> <td>0122456</td> </tr> <tr> <td>G3/8" female</td> <td>OCF30x90P.5R.G45W</td> <td>0121786</td> </tr> <tr> <td>3/8" NPT female</td> <td>OCF30x90P.5R.N47W</td> <td>0122459</td> </tr> </tbody> </table> | Thread | Code | Art. No. | G3/8" male | OCF30x90P.5R.G41M | 0122456 | G3/8" female | OCF30x90P.5R.G45W | 0121786 | 3/8" NPT female | OCF30x90P.5R.N47W | 0122459 | <table border="1"> <thead> <tr> <th>Thread</th> <th>Code</th> <th>Art. No.</th> </tr> </thead> <tbody> <tr> <td>G3/8" male</td> <td>OCF40x110P.5R.G40M</td> <td>0122457</td> </tr> <tr> <td>G3/8" female</td> <td>OCF40x110P.5R.G46W</td> <td>0122860</td> </tr> <tr> <td>3/8" NPT female</td> <td>OCF40x110P.5R.N48W</td> <td>0121865</td> </tr> </tbody> </table> | Thread | Code | Art. No. | G3/8" male | OCF40x110P.5R.G40M | 0122457 | G3/8" female | OCF40x110P.5R.G46W | 0122860 | 3/8" NPT female | OCF40x110P.5R.N48W | 0121865 |
| Thread | Code | Art. No. | | | | | | | | | | | | | | | | | | | | | | | | | | | | | | | | | | | | | |
| G3/8" male | OCF20x80P.5R.G41M | 0121847 | | | | | | | | | | | | | | | | | | | | | | | | | | | | | | | | | | | | | |
| G3/8" female | OCF20x80P.5R.G45W | 0122455 | | | | | | | | | | | | | | | | | | | | | | | | | | | | | | | | | | | | | |
| 3/8" NPT female | OCF20x80P.5R.N47W | 0121859 | | | | | | | | | | | | | | | | | | | | | | | | | | | | | | | | | | | | | |
| Thread | Code | Art. No. | | | | | | | | | | | | | | | | | | | | | | | | | | | | | | | | | | | | | |
| G3/8" male | OCF30x90P.5R.G41M | 0122456 | | | | | | | | | | | | | | | | | | | | | | | | | | | | | | | | | | | | | |
| G3/8" female | OCF30x90P.5R.G45W | 0121786 | | | | | | | | | | | | | | | | | | | | | | | | | | | | | | | | | | | | | |
| 3/8" NPT female | OCF30x90P.5R.N47W | 0122459 | | | | | | | | | | | | | | | | | | | | | | | | | | | | | | | | | | | | | |
| Thread | Code | Art. No. | | | | | | | | | | | | | | | | | | | | | | | | | | | | | | | | | | | | | |
| G3/8" male | OCF40x110P.5R.G40M | 0122457 | | | | | | | | | | | | | | | | | | | | | | | | | | | | | | | | | | | | | |
| G3/8" female | OCF40x110P.5R.G46W | 0122860 | | | | | | | | | | | | | | | | | | | | | | | | | | | | | | | | | | | | | |
| 3/8" NPT female | OCF40x110P.5R.N48W | 0121865 | | | | | | | | | | | | | | | | | | | | | | | | | | | | | | | | | | | | | |

BX75P



Suction cup with 2½ bellows

- ▶ Suitable for level adjustment and for uneven and porous surfaces such as cardboard, etc.
- ▶ In the two-coloured suction cup the bellows and the sealing lip are of different hardnesses, which makes the suction cup strong and stable and, at the same time, soft and flexible.
- ▶ DURAFLEX® suction cups manufactured in a specially developed material that features the elasticity of rubber and wear resistance of polyurethane.
- ▶ The material DURAFLEX® is mark free.

Lifting forces & Technical data

| Material | Lifting force vertical to the surface, N, at vacuum level | | | Lifting force parallel to the surface, N, at vacuum level | | | Volume cm ³ | Min. curve radius mm | Max. vertical movement mm | Weight rubber part g |
|-----------|---|---------|---------|---|---------|---------|---------------------------|-------------------------|------------------------------|-------------------------|
| | 20 -kPa | 60 -kPa | 90 -kPa | 20 -kPa | 60 -kPa | 90 -kPa | | | | |
| PU30°/60° | 62 | 110 | 141 | 39* | 83* | 116* | 80 | 23.0 | 26 | 71 |
| PU60° | 80 | 120 | 166 | 78* | 114* | 150* | 80 | 23.0 | 26 | 71 |

*The suction cup is not intended for handling shear lifts. The values are given as a dimensioning guide to be used when, e.g., the acceleration/retardation causes shear forces.

Material specifications

| Material | Colour | Hardness °Shore A | Temperature range °C |
|--------------------|--------------------|-------------------|----------------------|
| Polyurethane, PU30 | Yellow transparent | 30 | 10–50 |
| Polyurethane, PU60 | Green transparent | 60 | 10–50 |

Material resistance

| Wear resistance | Oil | Weather & ozone | Hydrolysis | Petrol | Concentrated acids | Ethanol | Methanol | Oxidation |
|-----------------|-----------|-----------------|------------|--------|--------------------|---------|----------|-----------|
| Excellent | Excellent | Excellent | Fair** | Fair | Fair** | Fair | Poor | Poor |

**Please contact Piab.

Ordering information

| | Complete suction cups | Art. No. |
|---|---|----------|
| A | Suction cup BX75P Polyurethane 30/60, G3/8" male / 1/8" NPSF female | 0106293 |
| A | Suction cup BX75P Polyurethane 30/60 with filter, G3/8" male / 1/8" NPSF female | 0106606 |
| B | Suction cup BX75P Polyurethane 30/60 with filter, thread insert G3/8" male | 0107151 |
| B | Suction cup BX75P Polyurethane 60 with filter, thread insert G3/8" male | 0107149 |
| C | Suction cup BX75P Polyurethane 30/60 with filter, 3/8" NPSF female | 0108794 |
| C | Suction cup BX75P Polyurethane 60 with filter, 3/8" NPSF female | 0108795 |

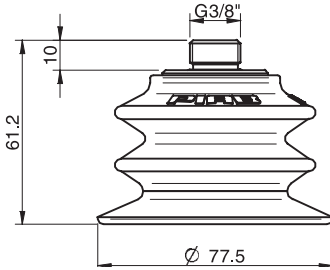

<Picture_Text changed="2004-04-27 10:49:37">A

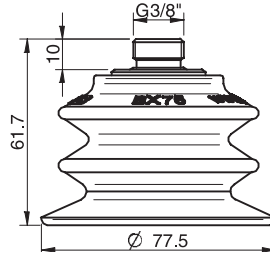

<Picture_Text changed="2004-04-27 10:49:57">B

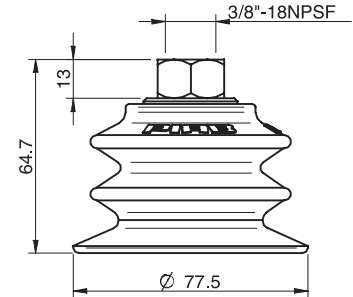

<Picture_Text changed="2004-08-24 13:46:52">C

| | Rubber parts | Art. No. |
|--|---|----------|
| | Suction cup BX75P Polyurethane 30/60 with filter, for thread insert | 0107145 |
| | Suction cup BX75P Polyurethane 60 with filter, for thread insert | 0107150 |

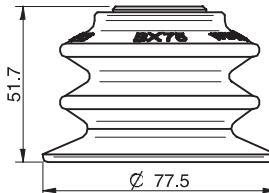

<Picture_Text changed="2004-06-24 16:06:50">

| | Fittings | Art. No. |
|--|---------------------------------------|----------|
| | Thread insert G3/8" male, with O-ring | 0106797 |

| Spare Part | Material | Temperature range °C | Art. No. |
|------------------|---------------|----------------------|----------|
| Filter for BX75P | Polyester/TPE | -40-90 | 0106374 |

B20



SUCTION CUP WITH SHORT BELLOWS

- ▶ Suitable for level adjustment. Several short bellows in one lifting device can handle objects with height differences and varying shapes, for example embossed or corrugated plates.
- ▶ The lifting movement can be used to separate small and thin objects.
- ▶ Only lightweight objects should be handled when the lifting force is parallel to the surface of the object, in order to achieve good precision and safe lifting movement.

LIFTING FORCES & TECHNICAL DATA

| Lifting force vertical to the surface, N, at vacuum level | | | Lifting force parallel to the surface, N, at vacuum level | | | Volume | Min. curve radius | Max. vertical movement | Weight rubber part |
|---|---------|---------|---|---------|---------|-----------------|-------------------|------------------------|--------------------|
| 20 -kPa | 60 -kPa | 90 -kPa | 20 -kPa | 60 -kPa | 90 -kPa | cm ³ | mm | mm | g |
| 5.9 | 9.8 | 14 | — | — | — | 2.7 | 10 | 10 | 3.2 |

MATERIAL SPECIFICATIONS

| Material | Colour | Hardness °Shore A | Temperature range °C |
|-----------------|--------|-------------------|----------------------|
| Chloroprene, CR | Black | 60 | -40–110 |
| Silicone, SIL | Red | 50 | -40–200 |

MATERIAL RESISTANCE

| Material | Wear resistance | Oil | Weather & ozone | Hydrolysis | Petrol | Concentrated acids | Alcohol | Oxidation |
|-----------------|-----------------|------|-----------------|------------|--------|--------------------|---------|-----------|
| Chloroprene, CR | Excellent | Fair | Good | Good | Fair | Poor | Good | Good |
| Silicone, SIL | Good | Poor | Excellent | Fair | Poor | Poor | Good | Excellent |

ORDERING INFORMATION

| | Complete suction cups | Art. No. |
|---|---|----------|
| A | Suction cup B20 Chloroprene, M5 female | 0101160 |
| A | Suction cup B20 Chloroprene, M5 female, with dual flow control valve | 0101166 |
| B | Suction cup B20 Chloroprene, G1/8" male, with mesh filter | 0101161 |
| B | Suction cup B20 Chloroprene, G1/8" male, with mesh filter and dual flow control valve | 0101167 |
| C | Suction cup B20 Chloroprene, G1/8" male/M5 female, with mesh filter | 0101165 |
| C | Suction cup B20 Chloroprene, G1/8" male/M5 female, with dual flow control valve | 0101169 |
| D | Suction cup B20 Chloroprene, 5xM5 female | 0101164 |
| A | Suction cup B20 Silicone, M5 female | 0101171 |
| A | Suction cup B20 Silicone, M5 female, with dual flow control valve | 0101177 |
| B | Suction cup B20 Silicone, G1/8" male, with mesh filter | 0101172 |
| B | Suction cup B20 Silicone, G1/8" male, with mesh filter and dual flow control valve | 0101178 |
| C | Suction cup B20 Silicone, G1/8" male/M5 female, with mesh filter | 0101176 |
| C | Suction cup B20 Silicone, G1/8" male/M5 female, with dual flow control valve | 0101180 |
| D | Suction cup B20 Silicone, 5xM5 female | 0101175 |
| D | Suction cup B20 Silicone, 5xM5 female, with dual flow control valve | 0101181 |
| E | Suction cup B20 Chloroprene, G1/8" male/M5 female, PA | 0110949 |
| E | Suction cup B20 Silicone, G1/8" male/M5 female, PA | 0110336 |

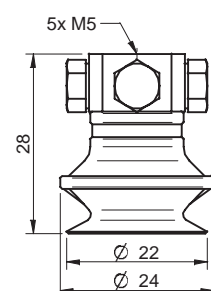
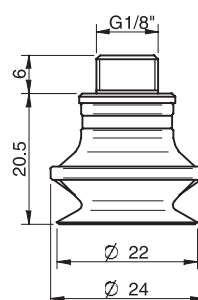
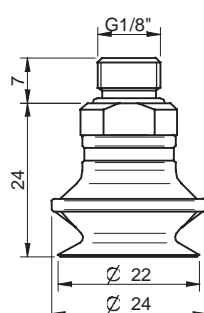
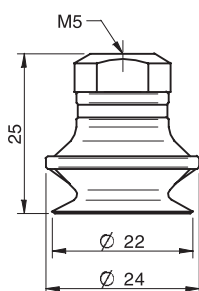

SUCTION CUPS B

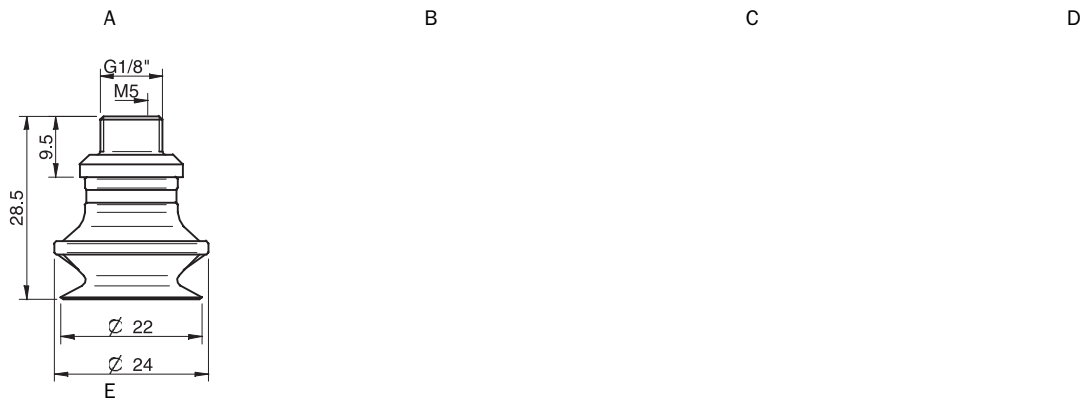

| Rubber parts | Art. No. |
|-----------------------------|----------|
| Suction cup B20 Chloroprene | 0101101 |
| Suction cup B20 Silicone | 0101102 |

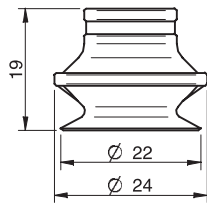

| Fittings | Art. No. |
|--|----------|
| Fitting M5 female | 3250003 |
| Fitting M5 female, with dual flow control valve | 3251001 |
| Fitting G1/8" male, with mesh filter | 3250085 |
| Fitting G1/8" male, with mesh filter and dual flow control valve | 3251002 |
| Fitting G1/8" male/M5 female, with mesh filter | 0101152 |
| Fitting G1/8" male/M5 female, with dual flow control valve | 3251004 |
| Fitting 5xM5 female | 0100260 |
| Fitting 5xM5 female, with dual flow control valve | 3251005 |
| Fitting G1/8" male/M5 female, PA | 3150196 |

For further information and dimensioned drawings, see SUCTION CUPS FITTINGS chapter.

Suction cups
B